

vtech[®]
Baby

Parent's Guide

Lullaby Lambs Mobile



VTech understands that a child's needs and abilities change as they grow and with that in mind we develop our toys to teach and entertain at just the right level...

vtech Baby

Toys that will stimulate their interest in different textures, sounds and colours

I am...

...responding to colours, sounds and textures

...understanding cause and effect

...learning to touch, reach, grasp, sit-up, crawl and toddle

Birth-36 months



Pre-School

Interactive toys to develop their imagination and encourage language development

I want...

...to get ready for school by starting to learn the alphabet and counting

...my learning to be as fun, easy and exciting as can be

...to show my creativity with drawing and music so my whole brain develops

3-6 years



Electronic Learning Computers

Cool, aspirational and inspiring computers for curriculum related learning

I need...

...challenging activities that can keep pace with my growing mind

...intelligent technology that adapts to my level of learning

...National Curriculum based content to support what I'm learning at school

4-10 years



To learn more about this and other VTech® products, visit www.vtech.co.uk

INTRODUCTION

Thank you for purchasing the **Lullaby Lambs Mobile** by **VTech®**. Gently soothe your baby to sleep with the soothing Lullaby Lambs Mobile. 3 modes of play allow a selection of nature and white noise sounds to play with 4 sing-along songs and 40 melodies. Watch the 3 soft lambs gently spin while the music plays and the colourful lights fade in and out from the projector.

NATURE
SOUNDS
BUTTON

MUSIC
BUTTON

LIGHT & MOTOR
CONTROL
BUTTON

5/15/30 TIMER
SWITCH

ON/OFF
SWITCH

VOLUME
CONTROL
BUTTONS

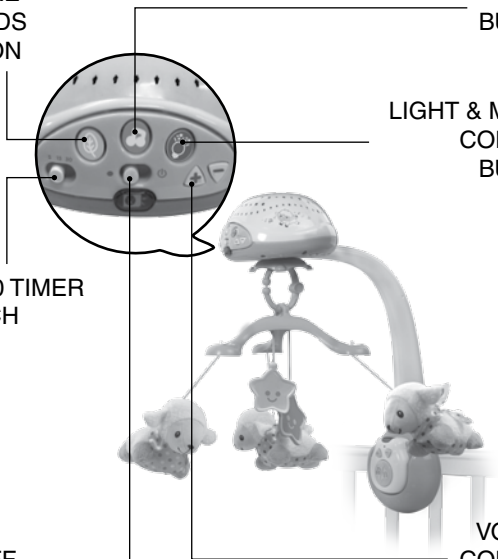

INCLUDED IN THIS PACKAGE

- One parent's guide



One remote control



One C ring



One ring attachment



Four screws



One mobile support post



Two plastic stars



Three soft lambs



Projector/mobile



Base unit



Chunky screw

WARNING: All packing materials such as tape, plastic sheets, packaging locks, removable tags, cable ties and packaging screws are not part of this toy, and should be discarded for your child's safety.

NOTE:

Please keep this parent's guide as it contains important information.

Unlock the packaging locks:

- ① Turn the packaging lock anticlockwise several times.
- ② Pull out and discard the packaging lock.

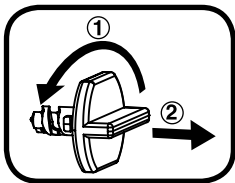

GETTING STARTED

BATTERY INSTALLATION

Lullaby Lambs Mobile

1. Make sure the unit is turned OFF.
2. Locate the battery cover on the bottom of the mobile. Use a screwdriver to loosen the screws.
3. Install 3 new AA (LR6/AM-3) batteries following the diagram inside the battery box. (The use of a new alkaline battery is recommended for maximum performance).
4. Replace the battery cover and tighten the screws to secure.

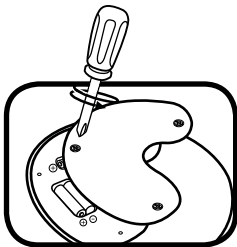

Remote Control

1. Locate the battery cover on the bottom of the remote control. Use a screwdriver to loosen the screw.
2. Install 2 new AAA (LR03/AM-4) batteries following the diagram inside the battery box. (The use of a new alkaline battery is recommended for maximum performance).
3. Replace the battery cover and tighten the screw to secure.

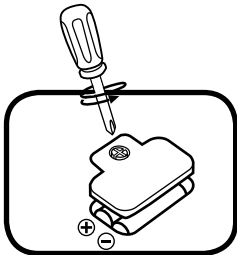

BATTERY NOTICE

- Use new alkaline batteries or fully charged NI-MH (Nickel Metal-hydride) rechargeable batteries for best performance.
- Use only batteries of the same or equivalent type as recommended.
- Do not mix different types of batteries: alkaline, standard (carbon-zinc) or rechargeable, or new and used batteries.
- Do not use damaged batteries.
- Insert batteries with the correct polarity.
- Do not short-circuit the battery terminals.
- Remove exhausted batteries from the toy.
- Remove batteries during long periods of non-use.
- Do not dispose of batteries in fire.
- Do not charge non-rechargeable batteries.
- Remove rechargeable batteries from the toy before charging (if removable).
- Rechargeable batteries are only to be charged under adult supervision.

Disposal of batteries and product



The crossed-out wheellie bin symbols on products and batteries, or on their respective packaging, indicates they must not be disposed of in domestic waste as they contain substances that can be damaging to the environment and human health.



The chemical symbols Hg, Cd or Pb, where marked, indicate that the battery contains more than the specified value of mercury (Hg), cadmium (Cd) or lead (Pb) set out in Battery Directive (2006/66/EC).

The solid bar indicates that the product was placed on the market after 13th August, 2005.

Help protect the environment by disposing of your product or batteries responsibly.

For more information, please visit:

www.recycle-more.co.uk

www.recyclenow.com

ASSEMBLY INSTRUCTIONS

With the VTech® Lullaby Lambs Mobile safety comes first. To ensure your child's safety, adult assembly is required.

1. Tighten the screws to secure the base cover.

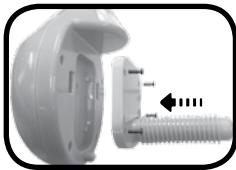

2. Attach and tighten the base to the cot using the chunky screw. Kindly note the spacing between the rails of cots should be between 25mm and 116mm wide. And the cross rail should not be wider than 58mm.

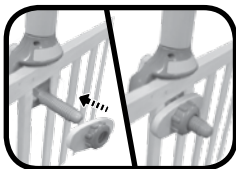

3. Insert the mobile support post into the base of the mobile, then insert the mobile support pole into the back of the mobile. You will hear a click when the pole is inserted correctly.

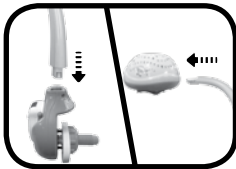

4. Connect the ring attachment into the bottom of the mobile using the C ring.

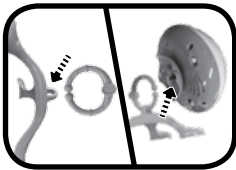

5. Attach the lambs to the three branches of the ring attachment, and the stars to the middle hole of the ring attachment. The mobile is now ready for use.

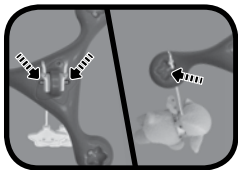

WARNINGS:

Adult assembly required. This package contains four screws. For your child's safety, do not let your child play with the toy until it is fully assembled.

To prevent possible injury by entanglement, remove this toy when the child starts trying to get up on its hands and knees in a crawling position.

PRODUCT FEATURES

1. On/Off Switch

To turn the Mobile ON, slide the ON/OFF SWITCH to the ON (⏻) position. To turn the Mobile OFF, slide the ON/OFF SWITCH to the OFF (●) position.

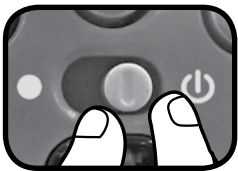

2. Automatic Shut Off

To preserve battery life, the **VTech® Lullaby Lambs Mobile** will automatically shut off after approximately 12 hours without input. The mobile can be turned on again by pressing any button. Pressing a button on the remote will not activate the mobile after 12 hours of no input.

NOTE: If the mobile repeatedly powers down while playing, we suggest changing the batteries.

ACTIVITIES

1. On/Off Switch

Slide the **On/Off Switch** to the **ON** position (⏻) to turn the unit **ON**. You will hear 4 soothing songs, then 20 soft melodies with nature sounds. The light pattern will fade in and out slowly to the music.

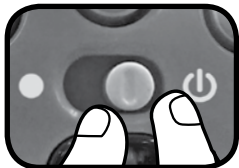

2. Timer Switch

Slide the **Timer Switch** to select how long the mobile will play for. When the time is up the unit will enter sleep mode. Timer options include 5, 15 or 30 minutes.

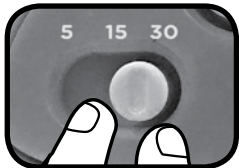

3. Light & Motor Control Button

Press the **Light & Motor Control Button** to select one of four light & motor modes.



4. Music Button

Press the **Music Button** to play 4 songs and 40 melodies in a loop. Press the **Music Button** again to play songs or melodies in a loop. The light pattern will fade in and out slowly to the music.



5. Nature Sound Button

Press the **Nature Sound Button** to hear combinations of nature sounds. The light pattern will fade in and fade out slowly with the sounds.



6. Volume Control Buttons

Press the **Volume Control Buttons** (+) (-) to turn the volume up or down.



7. Sound Sensor

When the **Lullaby Lambs Mobile** is in sleep mode, nature sounds or soft melodies will play when baby's cry is detected.



8. Remote Control

The **Remote Control** can start, pause and control the volume within 30 feet of the mobile. Be sure there are no obstructions directly between the **Remote Control** and the Remote Receiver. The **Remote Control** is disabled after 12 hours without input.



NOTE: Bright sunlight, artificial light and low battery power may reduce the Mobile's sensitivity to the **Remote Control**. To increase the reliability, reduce ambient light near the Mobile and make sure the batteries have power.

MELODY LIST

1. Schubert - Ave Maria
2. Blue Danube Waltz (Strauss)
3. Beautiful Dreamer
4. Cradle Song
5. Clair de Lune
6. Canon In D

7. Beethoven - Minuet in G
8. Chopin Berceuse, Op 57
9. Minuet - Luigi Boccherini - String Quintet in E Major, Op.11 No.5
10. Moonlight Sonata
11. Swan Lake Waltz - Tchaikovsky
12. Chopin - Nocturne Op.9 No.2
13. Kinderszenen Schumann
14. Berceuse - J. Brahms
15. Ode to Joy
16. Mozart - Turkish March
17. Mozart - Sonata No.16
18. Serenade Haydn
19. Beethoven - Fur Elise
20. Bach - Cello Suite No. 1 in G Major
21. All Through the Night
22. Baa Baa Black Sheep
23. Did You Ever See a Lassie?
24. Swing Low, Sweet Chariot
25. Hush Little Baby
26. Mary had a Little Lamb
27. Little Bo Bop
28. Are You Sleeping? (Frere Jacques)
29. Clementine
30. Danny Boy
31. My Bonnie Lies Over the Ocean
32. Do Your Ears Hang Low?
33. My Wild Irish Rose
34. Bicycle Made for Two
35. Ride a Cock Horse to Banbury Cross
36. Rock A Bye Baby

37. Sleep Baby Sleep
38. An Irish Lullaby
39. Take Me Out to the Ball Game
40. When the Saints go Marching In

SING-ALONG SONGS

SONG 1

Sleep sweet baby, warm and cosy
All through the night.
Let my singing gently guide you
Sweet dreams, good night.

SONG 2

Hush now, my sweet,
It's now time to rest
Close your eyes,
Sleep tight my love.

SONG 3

The stars are twinkling in the sky,
While the moon is perched and watches the world go by.

SONG 4

Hush, little baby, don't say a word.
It's time to sleep and have sweet dreams.

CARE & MAINTENANCE

1. Keep the unit clean by wiping it with a slightly damp cloth.
2. Keep the unit out of direct sunlight and away from any direct heat.
3. Remove the batteries when the unit will not be in use for an extended period of time.
4. Do not drop the unit on hard surfaces and do not expose the unit to moisture or water.

TROUBLESHOOTING

If for some reason the program/activity stops working or malfunctions, please follow these steps:

1. Please turn the unit **OFF**.
2. Interrupt the power supply by removing the batteries.
3. Let the unit sit for a few minutes, then replace the batteries.
4. Turn the unit **ON**. The unit will now be ready to play again.
5. If the product still does not work, replace with an entire set of new batteries.

If the problem persists, please call our Consumer Services Department on 03306780149 (from UK) or + 44 3306780149 (outside UK) and a service representative will be happy to help you.

IMPORTANT NOTE:

Creating and developing **VTech®** products is accompanied by a responsibility that we take very seriously. We make every effort to ensure the accuracy of the information, which forms the value of our products. However, errors sometimes can occur. It is important for you to know that we stand behind our products and encourage you to call our Consumer Services Department on 03306780149 (from UK) or + 44 3306780149 (outside UK), with any problems and/or suggestions that you might have. A service representative will be happy to help you.

CLASS 1
LED PRODUCT



PRODUCT REGISTRATION

Visit www.vtech.co.uk/clubvtech/login
to register your VTech product

By joining the VTech Club you can also enter competitions, find out about news and events, seek expert advice for parents and let your kids play fun learning games and activities.



PRODUCT WARRANTY

Thank you for choosing this quality product from VTech. We hope it will bring many hours of entertainment, imaginative play and learning.

1. The product detailed above is covered by a one year warranty from the date of purchase, against any defects in materials or workmanship.
2. The product may be returned to the place of purchase. Alternatively the product can be returned to VTech Electronics Europe plc (see address below), with proof of purchase, without proof of purchase no replacement will be provided.
3. VTech Electronics Europe plc will examine the product and if it is found to be defective due to faulty materials or workmanship, will replace the product at their discretion.
4. If the product covered by this warranty is damaged due to misuse, modification or unauthorised repair, or because of faulty batteries, battery discharge or incorrect electrical connections, then this warranty becomes void.
5. This warranty is personal to the original purchaser and is not transferable.
6. Breakages to the LCD screen are not covered by the warranty.
7. Returns to VTech Electronics Europe plc should include a cheque or postal order for £1.50 towards the cost of return postage and packaging.
8. Products returned to VTech Electronics Europe plc, should be addressed as follows and packed carefully to avoid damage in transit (Please do not include batteries or adaptor). Please include details of the fault together with your name and address.
9. To keep an online record of your warranty, please register your product online at www.vtech.co.uk/warranty

Vtech Electronics EU PLC, c/o XPO Logistics, Warehouse 350, Cat & Fiddle Lane, West Hallam, DE7 6HE

THIS WARRANTY IS OFFERED AS AN EXTRA BENEFIT AND DOES NOT AFFECT CONSUMERS' STATUTORY RIGHTS.

This warranty is valid for the UK and Eire only. For products purchased outside the UK and Eire, please contact your local distributor or place of purchase.

**Visit our website for more
information about our products,
downloads, resources and more.**

www.vtech.co.uk

